



AIX

Stainless Steel Unit Heater

TECHNICAL LEAFLET

# AIX

## Stainless Steel Unit Heater



**AIX Sabiana** unit heaters are made with stainless steel structures and coils with stainless steel pipes and flanged fittings, and aluminium fins. They are available in four sizes, for a total of eight models. These units can be supplied with hot water, high-temperature hot water and steam.

They are especially suitable for working environments in which these types of system configurations are required.



## TECHNICAL CHARACTERISTICS

- The **main casing** is manufactured from AISI 304 stainless steel, 1 mm thick.
- The **adjustable louvres** are held firm by spring loaded pivots and they are mounted in horizontal position on the front part of the unit.
- **Coil:** the fins are pressed from aluminium sheet, bonded onto the AISI 304 stainless steel tubes facilitating the maximum transfer contact. The AIX units are supplied with flanged connections.
- The **standard motor** is hermetically sealed and is maintenance free. The motor is 2 speeds, 3 phase, single voltage, 400V 50Hz, protection IP55, with klixon thermal protection.



AIX

### AIX identification code

Reference: 46I42

46	I	4	2
Motor 4/6 pole (1350/1000 r.p.m.)	Range AIX	Size 4	Rows 2

# AIX | DIMENSIONS, WEIGHT, WATER CONTENT

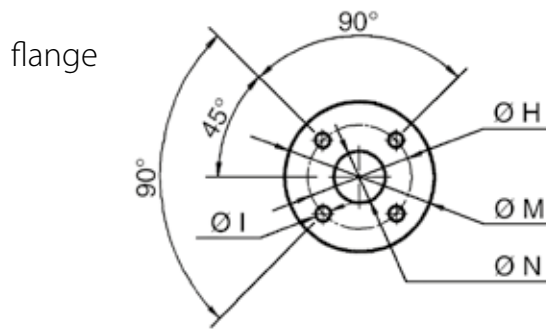
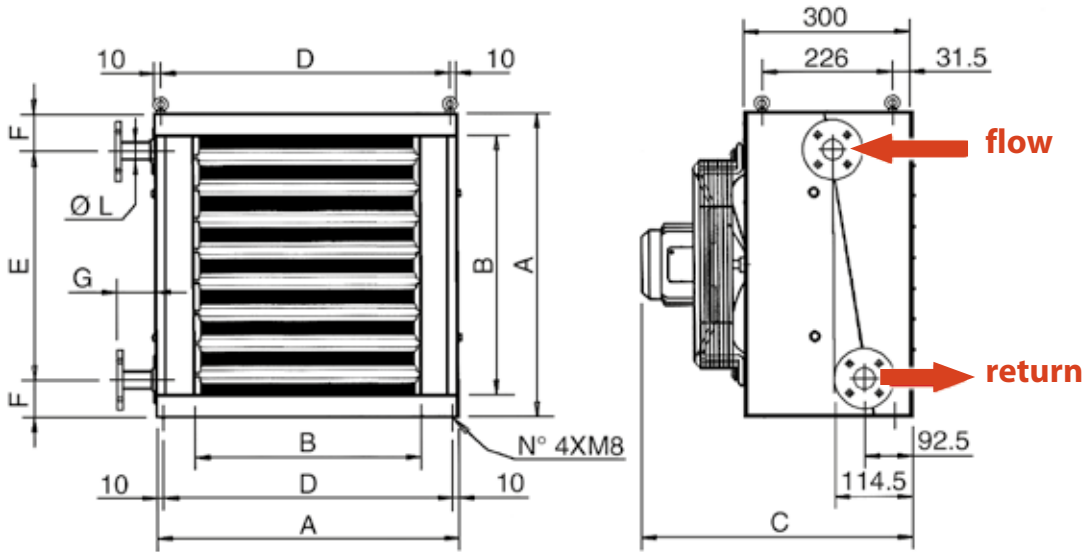

Model	A	B	C	D	E	F	G	ØH	ØI	ØL	ØM	ØN
<b>46 I 21-22</b>	526	393	468	506	330	98	66	65	14	½"	95	15
<b>46 I 41-42</b>	636	501	468	616	497	69.5	66	85	14	1"	115	25
<b>46 I 61-62</b>	743	609	468	723	588	77.5	56	100	18	1 ¼"	140	32
<b>68 I 91-92</b>	1011	877	576	991	832	89.5	87	110	18	1 ½"	150	40

Model	Weight kg		Water content liters	
	1R	2R	1R	2R
<b>46 I 21-22</b>	26	30	1,7	2,5
<b>46 I 41-42</b>	33	38	2,9	4,2
<b>46 I 61-62</b>	45	51	5,3	5,9
<b>68 I 91-92</b>	82	92	8,2	12

## Heating emission

Model		46 I 21		46 I 41		46 I 61		68 I 91	
<b>Mounting height</b>	m	2.5 ÷ 4		3 ÷ 4.5		3 ÷ 5		3.5 ÷ 5.5	
<b>Speed</b>	r.p.m.	1350	1000	1350	1000	1350	1000	900	700
<b>Air flow</b>	m <sup>3</sup> /h	2300	1500	3900	2600	6900	4400	10200	7600
<b>Throw</b>	m	11	7.5	16	12	25	18	28	21
<b>Noise level at 5 m (*)</b>	dB(A)	59	51	64	54	69	60	68	62
<b>Steam 3 bars</b>	kW	14,30	11,90	23,40	19,80	37,00	31,00	68,40	60,50
<b>Entering air temperature +15°C</b>	Leaving air temp. °C	33,3	38,3	32,6	37,4	30,8	35,7	34,7	38,4
<b>Steam 6 bars</b>	kW	16,50	13,80	27,00	22,90	42,70	35,90	79,00	70,00
<b>Entering air temperature +15°C</b>	Leaving air temp. °C	36,1	42	35,4	40,9	33,2	39	37,8	42,1

Model		46 I 22		46 I 42		46 I 62		68 I 92	
<b>Mounting height</b>	m	2.5 ÷ 4		3 ÷ 4.5		3 ÷ 5		3.5 ÷ 5.5	
<b>Speed</b>	r.p.m.	1350	1000	1350	1000	1350	1000	900	700
<b>Air flow</b>	m <sup>3</sup> /h	2100	1400	3600	2400	6300	4100	9200	7000
<b>Throw</b>	m	11	7.5	16	12	25	18	28	21
<b>Noise level at 5 m (*)</b>	dB(A)	59	51	64	54	69	60	68	62
<b>Water temperature 85/75°C</b>	kW	13,00	10,60	21,10	17,20	36,50	29,30	59,20	51,40
<b>Entering air temperature +15°C</b>	Leaving air temp. °C	33,2	37,3	32,2	36,1	32	36	33,9	36,6
<b>Water temperature 130/100°C</b>	kW	18,90	15,40	302,00	247,00	533,00	43,00	841,00	74,00
<b>Entering air temperature +15°C</b>	Leaving air temp. °C	41,5	47,3	39,7	45,3	39,9	45,8	41,9	46,1

(\*) = The sound pressure levels dB(A) are measured at a distance of 5m, directional factor Q = 2, compliant with the EN 3744 standard.

## Controls

**DSS**      **Delta-Star switch**  
for two speed Delta-Star motors, 4/6 or 6/8 poles.

**Manual two-position switch**  
for two speed Delta-Star motors, 4/6 or 6/8 poles.

**BS 2S**      without thermostat  
**BS 2-ST**    with thermostat

**Multi-function automatic control panel**  
for two speed Delta-Star motors, 4/6 or 6/8 poles.

**BSA-B**      without timer  
**BSA-A**      with manual daily timer  
**BSA-D**      with digital weekly timer



A company of Arbonia Group  
**ARBONIA** ▲

Follow us



Sabiana app



---

**SABIANA SpA**

Società a socio unico

Via Piave 53 - 20011 Corbetta (MI) Italia

T. +39 02 97203 1 r.a. • F. +39 02 9777282

info@sabiana.it

**www.sabiana.it**